

Digital

- Baxi Mago 5
- Baxi Air Connect + wi-fi module 9

Baxi Mago

The chronothermostat that simplifies your life



Baxi Mago is the modulating chronothermostat with integrated wi-fi, designed to simplify the life of installers and end users. It allows to control your home comfort (boiler, heat pump) via mobile application thanks to the wi-fi connection*, wherever you are.

The app can be downloaded from your smartphone or tablet and it is possible to connect one or more households to: control the heating, manage the schedule, display consumptions, display boiler fault diagnosis, set holiday mode, etc.

An innovative tool with a unique design, combining extreme ease of use and modern design.

BAXI MAGO
think simple!



OPENTHERM
ON/OFF



Aesthetically pleasing and easy to use!

Thanks to the knob and to the back-lighted display the temperature can be easily adjusted. The display screen is easy to read. Presence detection allows the unit to light up when you approach it. The intuitive menu has a top button to select and confirm operation and a bottom button to go back and return to Home screen.



Quick Auto Programming

Quick Auto Programming automatically creates a schedule based on your habits after answering a few questions..

* If the option is available in your country.



Multiple smartphones or tablets control option

Pairing the device allows the heating control, wherever you are. Multiple smartphones or tablets control option is available, so each member of the family can interact.



It follows your schedule!

Schedule your central heating to come on when you need it, setting two different weekly schedules. It is also possible to create five different scenarios related to multiple temperature requirements ("day", "night", "evening", "out of home", etc.).



Consumptions under control

It provides a guide to how much energy your heating system is using showing weekly, monthly or annual consumptions graphs.



It helps you saving money!





Baxi Mago allows you saving money on your energy bills: thanks to the control from smartphone or tablet, it is possible to reduce the temperature while you are away, with saving on consumptions. Furthermore, it modulates the power of the boiler with less consumptions both on heating and DHW production.

Baxi Mago



- Chronothermostat with integrated wi-fi module
- To connect Baxi Mago to the domestic internet, it is not necessary to connect other devices to the router
- Remote control APP for smartphones and tablets only
- It is possible to connect one or more households for temperature control, weekly plan management, holiday mode selection etc.
- Multiple device management: it is possible for more than one person to interact with the chronothermostat
- Quick Auto Programming automatically creates a schedule based on your habits after answering a few questions

BAXI MAGO
think simple!

Model		Code
	Chronothermostat Baxi Mago with integrated wi-fi module + adapter kit GTW16 (OpenTherm and ON/OFF)	 7652303
	Chronothermostat Baxi Mago with integrated wi-fi module (R-BUS)	 7701201

Technical drawings/graphs

BAXI MAGO

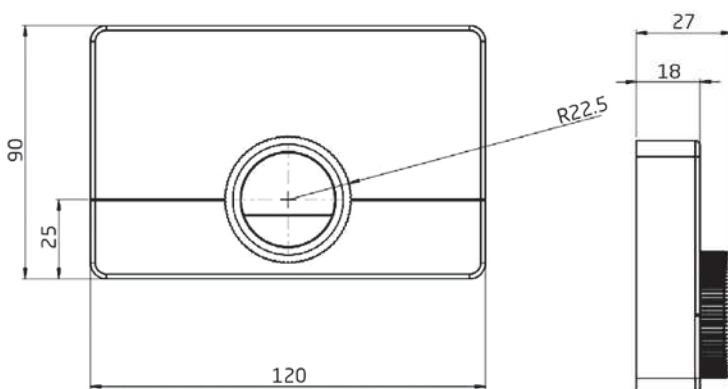

The dimensions of Baxi Mago have been designed in order to cover the electric Box 503

ADAPTER KIT (GATEWAY)

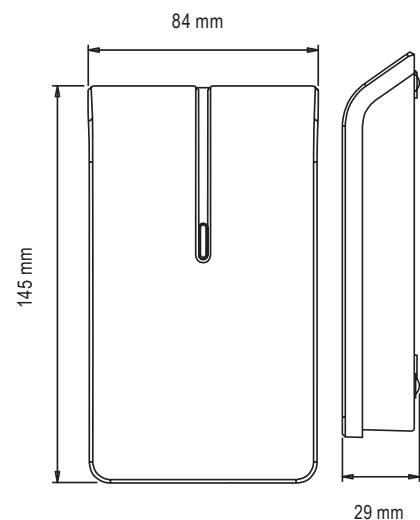

Installation schemes

Baxi Mago + GTW16 (Modulating OpenTherm or On/Off)

- 1) Adapter kit connection (OpenTherm or On/Off *)
- 2) Adapter kit (GTW16) with 24V transformer
- 3) Baxi Mago connection (R-Bus; 2 wires, possibly shielded cables)
- 4) Domestic wi-fi connection to the Router
- 5) Connection with App Baxi Mago

* to locate OpenTherm terminal in the boiler, see boiler technical guide

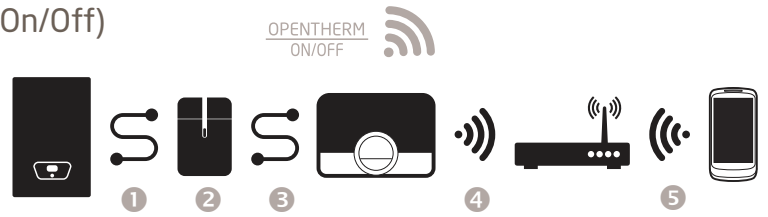

Baxi Mago

- 1) Baxi Mago connection (R-Bus; 2 wires, possibly shielded cables)
- 2) Domestic wi-fi connection to the Router
- 3) Connection with App Baxi Mago

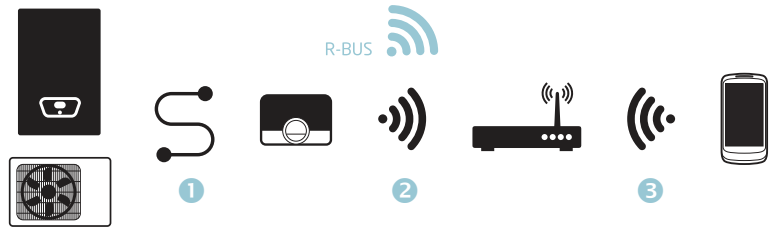

Packages

Baxi Mago + GTW16 for products with OpenTherm protocol

1) Baxi Mago package:

- Baxi Mago
- Screw and plug fixings
- Mounting bracket for wall hung installation
- User guide

2) Gateway package:

- Adapter kit or Gateway (GTW)
- Power adapter, exposed wires to be connected inside the boiler
- Screw and plug fixings
- Installation guide

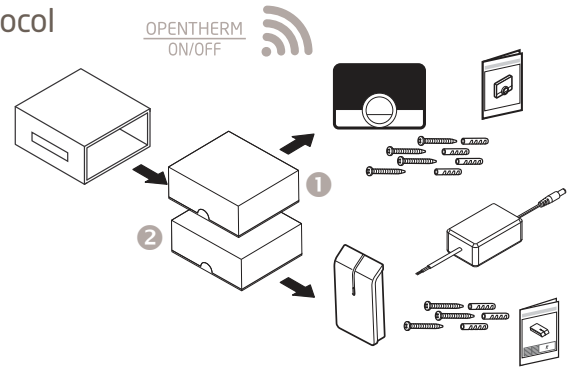

Baxi Mago for products with R-BUS protocol

1) Baxi Mago package:

- Baxi Mago
- Screw and plug fixings
- Mounting bracket for wall hung installation
- User guide

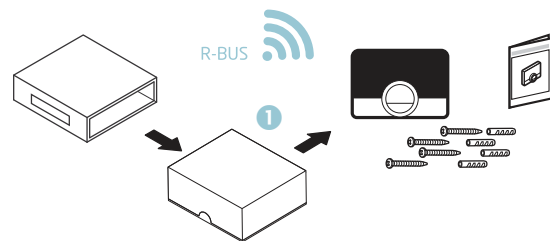

Technical data

Dimensions	
Width x height x depth (Baxi Mago)	120 x 90 x 27 mm
Width x height x depth (Gateway) - only for Baxi Mago with OpenTherm or ON/OFF protocol	84 x 145 x 29 mm
Electrical power supply	
Bus connection voltage	24 V ± 5%
Maximum electrical consumption	1,5 W
Electrical connection	
Maximum cable length for dedicated Baxi Mago bus	50 m
Maximum cable resistance	2 x 5 ohm
Ambient conditions	
Operating conditions	from 0 °C to 60 °C
Temperature	
Measurable room temperature range	from 5 °C to 60 °C
Maximum temperature deviation at 20°C	0,3 °C
Maximum room control overshoot after pre-heating	1 °C
Temperature variation	+/- 0,5 °C
Temperature control range	from 10 °C to 30 °C

Baxi Air Connect: Smart Comfort

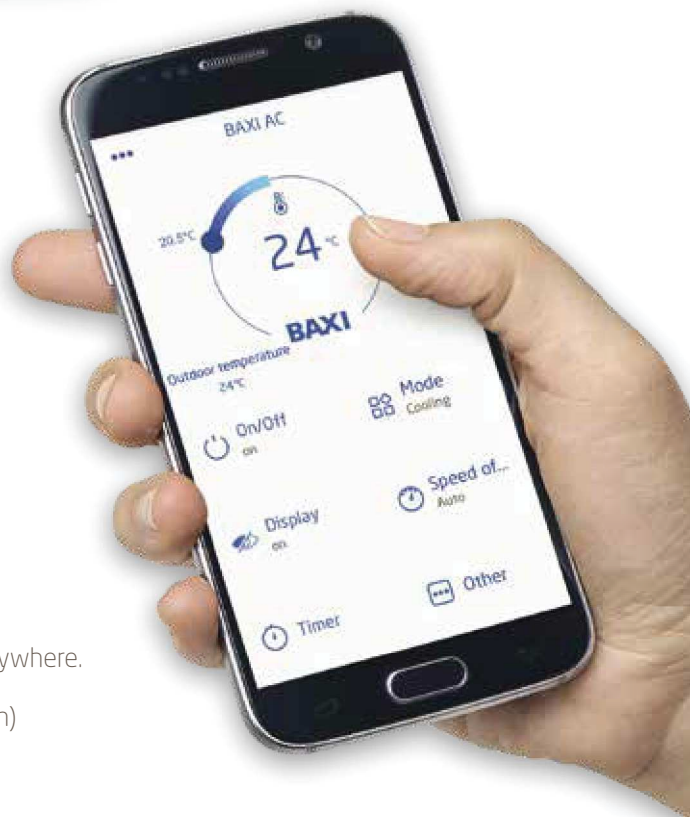
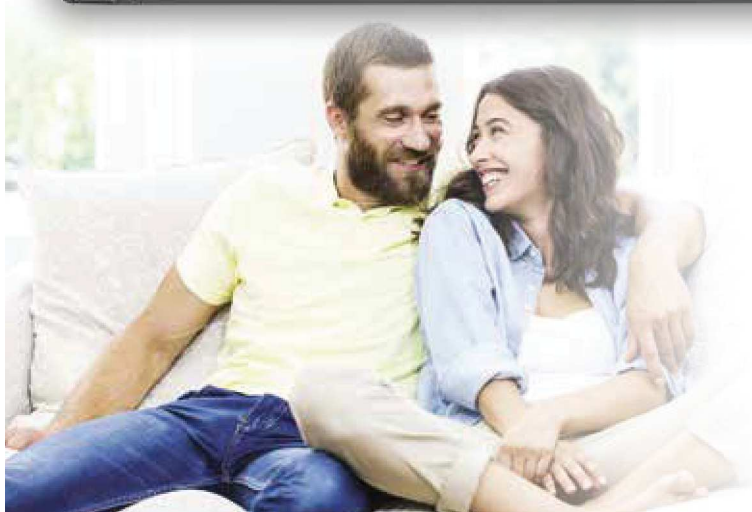

The Air Connect App and the wi-fi module allow the remote control of Baxi Luna Clima air conditioners.

Air Connect is the application to have the full control of the temperature and the comfort of the house or of the office at any moment and from everywhere.

Once the wi-fi module is installed (see the installation manual for instruction) and Air Connect is downloaded, it is possible to control the air conditioners from smartphones and tablet (iOs and Android system).

It is possible to:
 turn on/off the air conditioner, choose the operating mode, set the fan speed, set the flip horizontal and vertical swing (where it is possible), display all active functions, set a timer, etc.



Baxi Air Connect + wi-fi module



Air Connect means easy and intuitive comfort control:

- Direct and easy connection to Baxi air conditioner via smartphone and tablet.
- No visual impact: the wi-fi module is installed in the dedicated location behind the frontal panel of the air conditioner (wall hung models) or inside the air conditioner (Light Commercial models).
- Easy scheduling of the timetable that combines comfort and significant energy savings.
- More indoor units can be controlled with the same application (Multi split models), as long as a wi-fi module is installed in each unit.
- Same functions as the remote control directly from your device, for example: Turbo, Sleep, iClean, etc.



Model	Code
Air Connect wi-fi per Luna Clima	7660110

Technical data

Wi-fi module dimensions (to install behind the frontal panel)	
Dimensions (wxhxd) mm	57,8x36,4x8,0
Electrical power supply	
Connection voltage	12 V + 2,5%
Ambient conditions	
Operating conditions	From -10 °C to 80 °C
Operating frequency	
Functioning frequency	2.412~2.472 GHz
Others	
Protocol	IPv4, TCP/UDP/FTP/http/HTTPS/TLS/mDNS
Safety	WEP/WPA/WPA2
Type of network	STA/AP/STA+AP/WIFI Direct

Wi-fi module package contents

The packaging includes: wi-fi module, Light Commercial connection cable, start guide and warranty certificate.

Terms of service

The application can be used with more Baxi indoor units, as long as a wi-fi module is installed in every unit.